

# FORCE-48

## Quick Start Guide



**SPYPOINT**

v1.1

## IN THE BOX

FORCE-48



INSTALLATION  
STRAP

## NOTE

**Batteries sold separately.**

User Manual, software updates & FAQs available at:  
**[www.sypoint.com/support](http://www.sypoint.com/support).**

## COMPONENTS

- 1 No glow flash
- 2 Red LED indicator
- 3 Photo lens
- 4 Detection lens
- 5 Cable lock hole
- 6 Slot for installation strap
- 7 Locking latch
- 8 12 V jack
- 9 Screw-thread for standard 1/4"-20
- 10 LCD screen
- 11 OK button
- 12 Switch ON/SETUP/OFF
- 13 Navigation buttons
- 14 SD card slot
- 15 Battery compartment

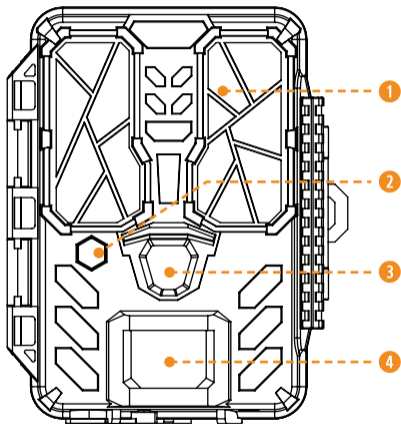

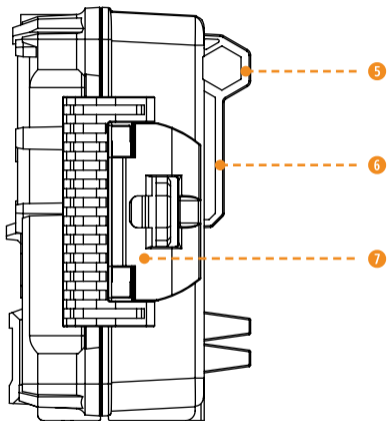

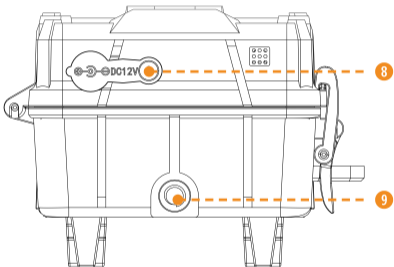

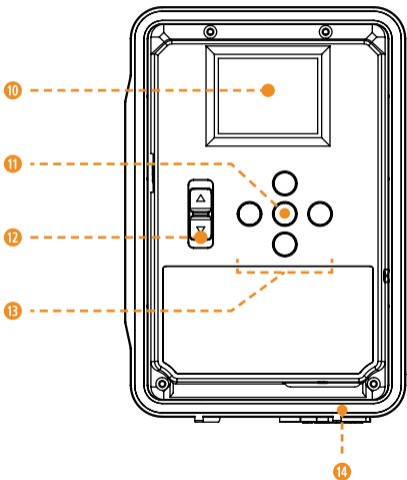

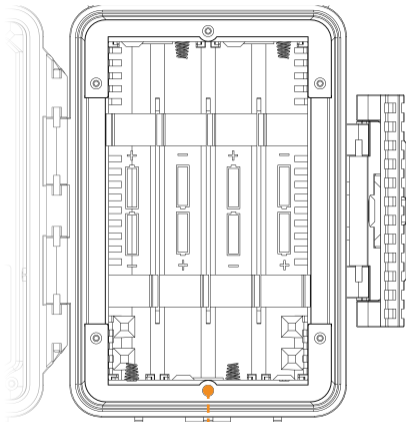

## PREPARATION

### SELECT A POWER SOURCE

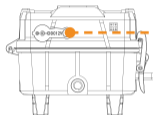

12V  
Power Source

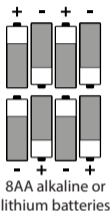

You can use any combination of the above power sources with your FORCE-48. If multiple power sources are connected, the camera will use them in the following order: 12V, and then the AA.

## FOR MAXIMUM PERFORMANCE AND WITHOUT LEAKING BATTERIES

- Use new batteries.
- Use ONLY alkaline or ONLY lithium batteries.
- Do not mix new and old batteries.
- Do not use rechargeable AA batteries, as their lower voltage may cause operating difficulties.

## INSTALLING AN SD CARD

The camera was designed to operate with an SD card between 2 and 512 GB of memory.

### INSERT AN SD CARD

- Make sure the camera is turned OFF.
- Locate the SD card slot. It is on the bottom right corner of the camera (see diagram).
- Insert an SD card (up to 512 GB) in the slot and make sure to respect the direction indicated in the diagram.
- The card is inserted correctly when a click is heard.

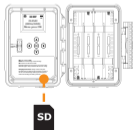

## FORMAT YOUR SD CARD

After inserting your SD card, you will need to navigate to the Format option in the settings. Use the onscreen prompts to format the SD Card.

## GENERAL SETTINGS SETUP

Use the ▲▼◀▶ buttons to switch to the LCD display or to change options, and press OK to select. Several setup pages will be displayed.

1. To turn the camera ON/OFF, use the ON/SETUP/OFF switch.
2. The switch must be on SETUP to make your initial changes.
3. When the switch is on SETUP, press OK to open the MENU:
  - Set the **language** (English, Français, Deutsch)
  - Set the **date** (MM/DD/YY or DD/MM/YY)
  - Set the **time** (12h or 24h)
  - Set the **temperature** (°F/ °C)



## SETUP

### ADJUST THE SETTINGS FOR THE 3 MODES OF OPERATION

#### PHOTO MODE

**Delay:** Allows you to select the time elapsed before the camera can detect again and take the next photo.

If you want to capture multiple photos, use a shorter delay. Once you have selected the delay, press OK.

**Quality:** Allows you to select a resolution of 2MP, 8MP, 16MP, 30MP or 48MP. Once you have made your selection, press OK.

**Multi:** Allows you to select the number of photos to be taken per shot (from 1 to 5 photos). Once you have made your selection, press OK.

**Detect:** Allows you to set motion-detector sensitivity (LOW, NORMAL, HIGH, AUTO). Once you have made your selection, press OK.

## **VIDEO MODE**

**Delay:** Allows you to select the time elapsed before the camera can detect again and take the next video.

**Quality:** Allows you to choose between 480P and 720P. Once you have made your selection, press OK.

**Length\*:** Allows the user to choose the video length (10 to 60 s). Once you have made your selection, press OK.

**Detect:** Allows you to set motion-detector sensitivity (LOW, NORMAL, HIGH, AUTO). Once you have made your selection, press OK.

## **TIME-LAPSE**

Allows you to take photos at regular predefined intervals without necessarily detecting a movement.

---

\*When selecting a "Video Length" over 20 seconds, only daytime videos will be affected . Nighttime videos are limited to 20 seconds to preserve battery life.

## **OTHER OPTIONS**

**Night:** Choose the BOOST option for maximum brightness at night, select OPTIMAL to reduce fuzziness at night, and MIN BLUR to minimize the blurriness of moving objects. Once you have made your selection, press OK.

**Name:** Allows to give a name to your camera.

**About:** Indicates the software version.

**Default:** Resets all default settings

**Format:** Allows the camera to format the SD card the next time it is used. (Reformatting the SD card will delete all photos and videos on the card. Only format the card if you are sure you want to delete everything on it. Transfer all data to your computer beforehand).

## OPERATION

Once the setup is complete, turn the button from SETUP to ON. You may also switch from SETUP to OFF and turn the device ON later.

### RED LIGHT ON THE FRONT OF THE CAMERA

When the switch is in the SETUP position, the red light will flash to confirm a motion detection once you have adjusted your settings.

When you move the switch to the ON position, the red light at the front of the camera will flash for 30 seconds to allow you to move out of the camera's field of view.

When the light turns off, the camera is ready for use.

## INSTALLATION

### **Recommended height of installation:**

The camera must be installed at the height of the centre line of the animal's body.

### **Ideal setup for high-quality images and videos:**

The target animal should be 7.5 m from the camera to get a better line of sight.

To produce brighter photos at night, there should be items reflecting the camera's flash in the background.

Please note that the camera should never be directly pointed at the sun to avoid back lighting and faulty detections.



**Scan for detailed instructions, LED light pattern descriptions, complete user manual & other helpful information:**

[spypoint.com/force48-guide](http://spypoint.com/force48-guide)

Need assistance?  
Just contact us!

**INTERNATIONAL**

[spypoint.info/en/support-2/](http://spypoint.info/en/support-2/)  
+49 (0) 36331-403333

**CAN/US**

[spypoint.com/support](http://spypoint.com/support)  
1-888-779-7646

2-year limited warranty, visit [spypoint.com/garantie](http://spypoint.com/garantie) for complete details.

Made in China

# FORCE-48



More information available  
in the certifications guide